

Customer	Date	9/12/2019
Contact	Project	
Phone number	Project no.	
Email		

LNES 65-160/75/P25VCS4

101882950

Operating data

Pumpe type	Single head pump	Fluid	Water
No. of pumps / Reserve	1 / 0	Operating temperature t A	°C 4
Nominal flow	m³/h 47	pH-value at t A	7
Nominal head	m 27	Density at t A	kg/m³ 1000
Static head	m 0	Kin. viscosity at t A	mm²/s 1.569
Inlet pressure	kPa 0	Vapor pressure at t A	kPa 100
Environmental temperature	°C 20	Solids	0
Available system NPSH	m 0	Altitude	m 0

Pump data

Make	Lowara	Nominal	m³/h 49 (49)
Speed	rpm 2900	Flow	Max- m³/h 97
Number of stages	1	Min-	m³/h 21.7
Max. casing pressure	kPa	Nominal	m 29.4
Max. working pressure	kPa 328.1	Head	at Qmax m 14.4
Head H(Q=0)	m 33	at Qmin	m 32
Weight	kg	Shaft power	kW 5.8 (5.8)
Max.	mm 176	Max. shaft power	kW 7.1
Impeller R	designed	Efficiency	% 67.41
Min.	mm 144	NPSH 3%	m
Suction nozzle	DN 65 PN 16 EN1092-2 (NSC-LNE)	Discharge nozzle	DN 65 PN 16 EN1092-2 (NSC-LNE)

Pump Materials

Volute casing	Cast iron
Casing cover	Cast iron
IMPELLER	Stainless steel / AISI 304
Stub shaft	Stainless steel / AISI 316L
WEAR RING	Stainless steel / AISI 304
Impeller lock nut and washer	Stainless steel / AISI 304
Impeller key	Stainless steel / AISI 316L
Fill and drain plugs	Nickel-plated brass

Shaft Seal

Unbalanced mechanical seal	
eMG12 (-25 / +90 °C)	Burgmann
Rotating Assembly	Resin impregnated carbon
Fixed Assembly	Silicon Carbide
Elastomers	EPDM
Springs	AISI 316
Other Components	AISI 316

Motor data

Manufacturer	Lowara	Electric voltage	400 V
Specific design	IE3 Three phase surface motor		
Type	PLM132.../375 E3		
Rated power	7.5 kW	Electric current	14.1 A
Speed	2935 rpm	Degree of protection	IP 55
Frame size	132	Weight	57 kg
Shaft diameter	0 mm	Colour	RAL 5010
Insulation class	F		

Coupling

Manufacturer	
Series	
Type	
Frame size	
Spacer length	
Weight	
Coupling protection	

Base plate

Description
Weight

Remarks:

Customer	Date	9/12/2019
Contact	Project	
Phone number	Project no.	
Email		

LNES 65-160/75/P25VCS4

101882950

Hydraulic data

Operating Data Specification		Hydraulic data (duty point)		Impeller design	
Flow	47 m³/h	Flow	49 m³/h	Impeller R	159 mm
Head	27 m	Head	29.4 m	Frequency	50 Hz
Static head	0 m	MEI >=0,4		Speed	2900 rpm

Power datas referred to:

Water [100%] ; 4°C; 1000kg/m³; 1.57mm²/s

Performance according to ISO 9906:2012 – Grade 3B

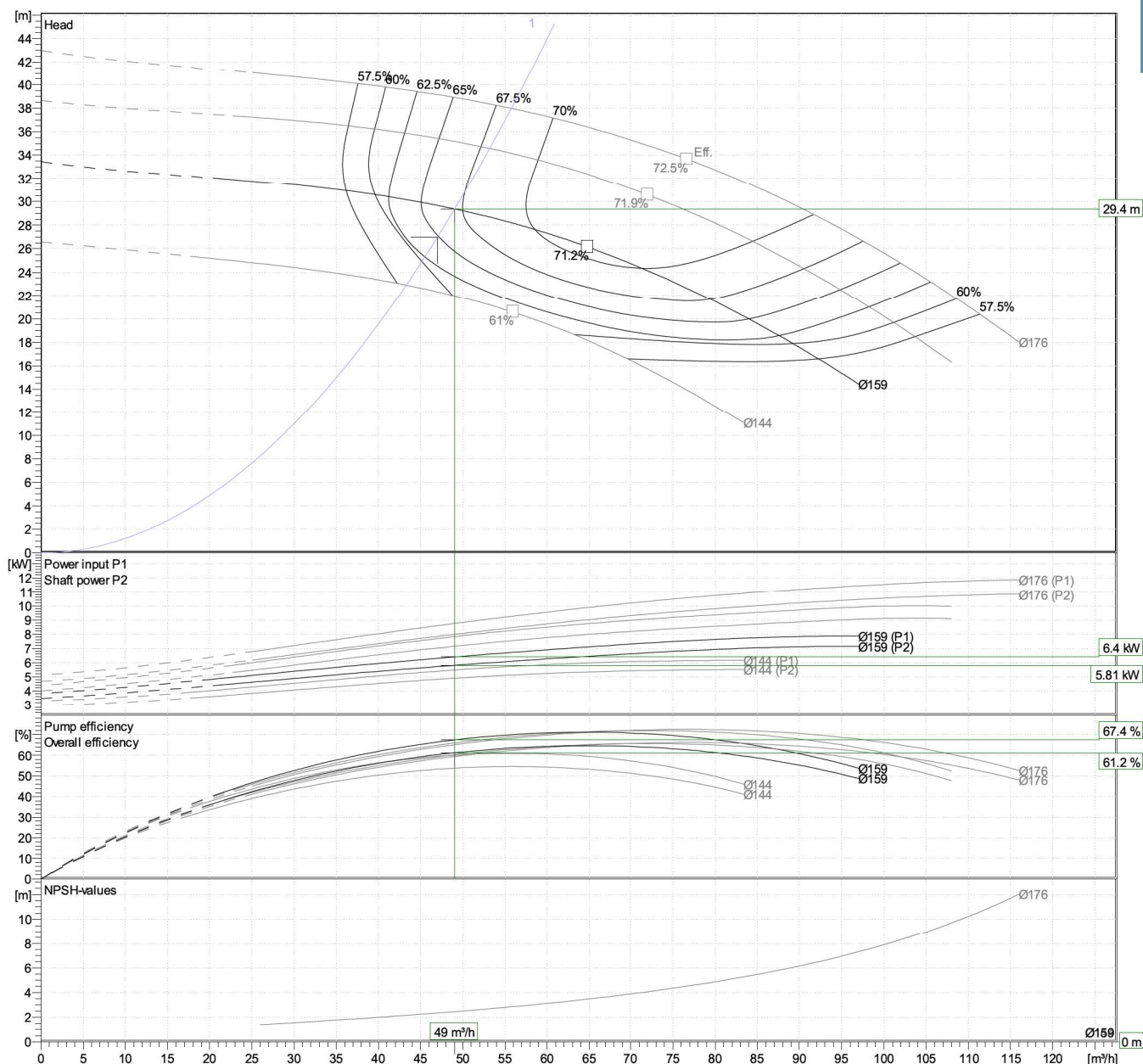

Customer	Date
Contact	Project
Phone number	Project no.
Email	

LNES 65-160/75/P25VCS4

101882950

Dimensions mm/l

AD	191		
b1	148		
Bmax	339		
DND	65		
DNS	65		
e	105		
f	217		
H	360		
h1	190		
h2	170		
L	689		
p	256		
x	94		
Total weight		96 kg	

Connections mm

Suction nozzle	Discharge nozzle
DN 65	DN 65
PN 16	PN 16
EN1092-2 (NSC-LNE)	EN1092-2 (NSC-LNE)

C	20	C	20
D	185	D	185
df	118	df	118
DN	65	DN	65
K	145	K	145
L	4 x 19	L	4 x 19

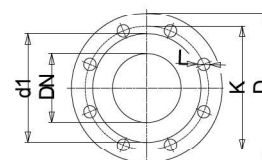

Value C, D may vary from Standard

Drawing

